



# megamount 2-30T

## ELECTRO-HYDRAULIC UNIVERSAL TYRE CHANGER FOR TRUCKS AND BUSES



### Self-centering chuck

The self-centering chuck, mounted on the movable spindle arm, has 4 jaws with locking capacity from 14" to 30" and performs a 1-speed rotation in two directions.

With its design is adaptable to all shapes and rim profiles always ensuring perfect locking. The self-centering chuck operates by means of a high pressure hydraulic circuit to handle all types of steel and alloy rims and it is adjustable up to 110 bar.

### Tool-holder arm

The tool-holder arm is easily manually adjustable in direction and inclination and allows, with a simple movement, to choose the tool suitable for the phase of bead-breaking, tool-assisted extraction and mounting of the tyre. The quick unlocking system ensures ease and speed during operation change.

The tool-holder arm slides along the tool-holder carriage to position itself on the outer and inner side of the rim.

### Control unit

The machine is equipped with a low voltage portable control unit, easily movable inside the working area. The rational lay-out of control levers, buttons and pedals prevents the operator from making accidental operational errors.

The control unit also controls the translational movement of the tool-holder carriage.

## Standard accessories



Bead lifting lever



Aluminum rim clamp

## Optional accessories



Set of 4 plastic protections for aluminum rims



Ring protection for 22,5" alloy rim

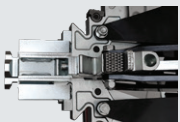

Adaptor for internal hole 100 mm (1 pc)

## Optional set up



Emergency red button for the immediate halt of the unit.

## Versions on request

Version at 230V / 50-60 Hz / 3-phase

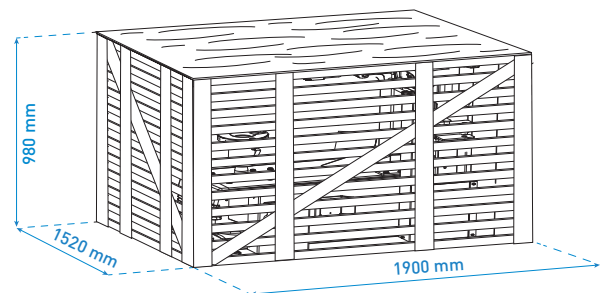
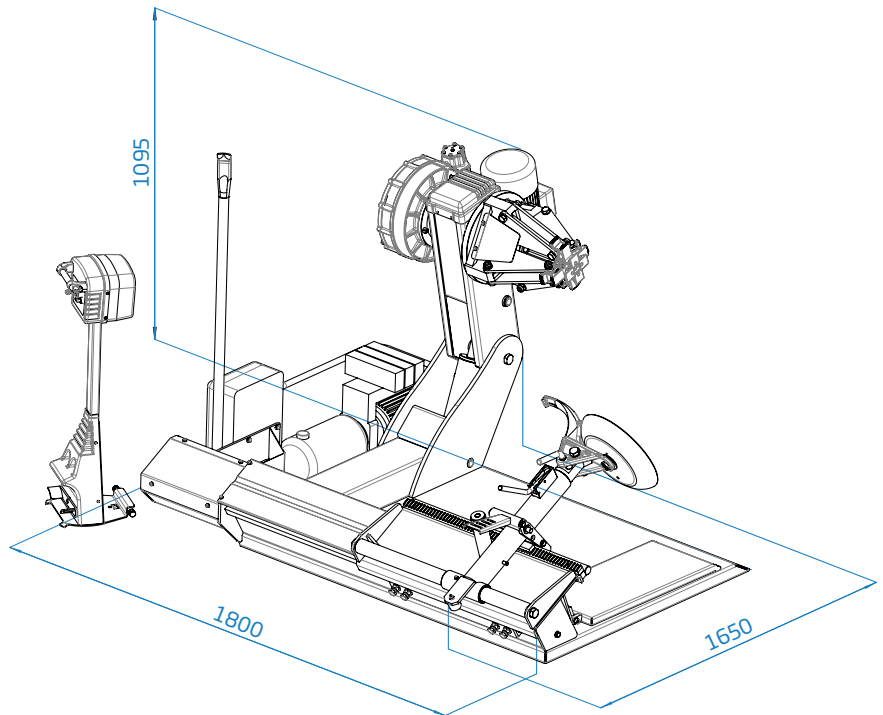

## Technical Data

Clamping capacity	10" ÷ 30"
Max wheel diameter	1640 mm (65")
Max wheel width	850 mm (34")
Max wheel weight	1200 kg
Max bead-breaking power	25.000 N
Speed of rotation	7 rpm
3-Phase motor	1.5 kW (2 hp)
Power supply	400 V/3/50-60Hz
Net weight	605 kg



**HOFMANN MEGAPLAN GmbH**  
 Hüttenstrasse 7 - 67550 Worms - Germany  
 T +49 (0)6242 913 6666 - hm-mail@hofmann-megaplan.com  
[www.hofmann-megaplan.com](http://www.hofmann-megaplan.com)